

Subplot area table for Old S.No.-147, FP-314 of TPS-3A of DSIRDA

Subplot Number	Dimensions (mt)	Carpet area (sqmt)	Super builtup area (sqmt)	Carpet area (sqyd)	Super builtup area (sqyd)
1	54.01 X 30.25 = 1633.80 Less Curve = 12.06	1621.74	2405.61	1939.60	2877.11
2	29.99 X 54.01	1619.76	2402.68	1937.23	2873.60
3	29.99 X 54.01	1619.76	2402.68	1937.23	2873.60
4	29.99 X 54.01	1619.76	2402.68	1937.23	2873.60
5	29.99 X 54.01	1619.76	2402.68	1937.23	2873.60
6	29.99 X 54.01	1619.76	2402.68	1937.23	2873.60
TOTAL		9720.54	14419.00	11625.77	17245.12

Subplot area table for Sandhida-514 of TP3A of DSIRDA

Subplot Number	Dimensions (mt)	Subplot area (sqmt)	Permissible ground coverage as per GDCR @ 40%	Permissible FSI as per GDCR @ 2
1	54.01 X 30.25 = 1633.80 Less Curve = 12.06	1621.74	648.70	3243.48
2	29.99 X 54.01	1619.76	647.90	3239.52
3	29.99 X 54.01	1619.76	647.90	3239.52
4	29.99 X 54.01	1619.76	647.90	3239.52
5	29.99 X 54.01	1619.76	647.90	3239.52
6	29.99 X 54.01	1619.76	647.90	3239.52
Total		9720.54	3888.22	19441.08

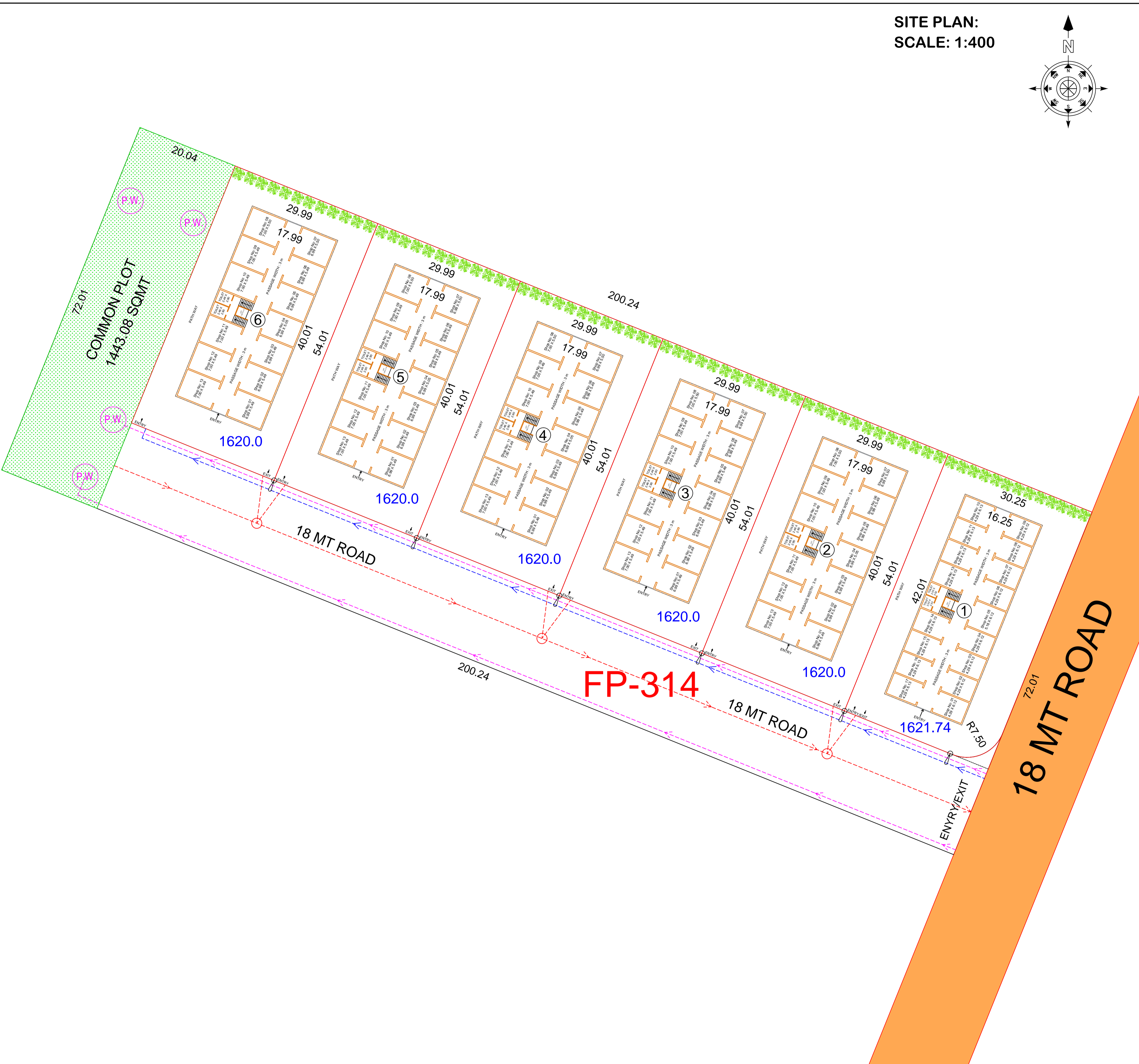

SITE PLAN:
SCALE: 1:400

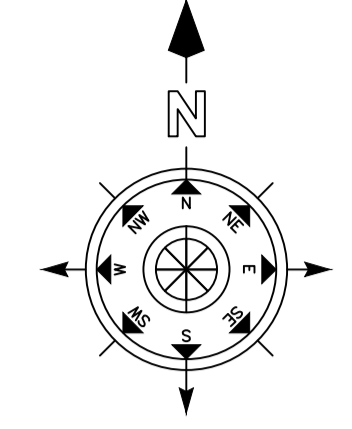

PROPOSED COMMERCIAL BUILDING AT NEW SURVEY NUMBER 514 (OLD 147) VILLAGE SANDHIDA, TALUKA DHOLERA DISTRICT AHMEDABAD PRELIMINARY TP SCHEME No. 3A OF DSIRDA OP No. 314 FP No. 314

**ZONE: HIGH ACCESS CORRIDOR
USE: COMMERCIAL**

AREA TABLE

DISCRIPTION	AREA IN SQ.MT.
AREA OF SURVEY No. 514	28838.00
AREA OF OP No. 314	28838.00
AREA OF FP No. 314	14419.00
AREA OF INTERNAL ROAD	3255.38
AREA OF COMMON PLOT REQUIRED AS PER GDCR @ 10%	1441.90
AREA OF COMMON PLOT PROVIDED	1443.08
AREA OF SUB-PLOTS	9720.54

FSI TABLE
TOTAL AREA OF SUBPLOTS - 9720.54 SQMT
TOTAL PERMISSIBLE FSI @ 2 - 19441.08 SQMT

CALCULATION FOR PERCOLATION WELL
1 PERCOLATION WELL / 4000 SQ.MT.
14419.0 / 4000 SQ.MT. = 3.60 PERCOLATION WELL REQUIRED
NUMBER OF PERCOLATION WELL PROVIDED = 4

CALCULATION FOR COMMON PLOT
COMMON PLOT : 20.04 X 74.01 = 1443.08 SQMT

CALCULATION FOR TREE PLANTATION
TOTAL PLOT AREA = 14419.00 SQMT
TOTAL SUBPLOT AREA = 9720.54 SQMT
TOTAL TREE PLANTATION REQUIRED
1 Tree / 100 sqmt of builtup area
Total permissible FSI = 19441.08 sqmt
19441.08 / 100 = 194.41 (Say 194 Trees)
Proposed trees = 195

- LEGEND**
- N OP No. & Boundary
 - N FP No. & Boundary
 - DP / TP Road
 - Proposed Internal Roads
 - Proposed Common Plots
 - Proposed Sub-Plots
 - Proposed drainage line
 - Proposed water supply line
 - Proposed storm water collection line
 - Proposed Light poles

SPECIFICATIONS
DRAINAGE SYSTEM: Under ground cement pipe at the centre of road
ROAD: Finished with good quality paver blocks
STORM WATER CHANNEL: RCC storm water channel on both sides of road with grill cover
STREET LIGHT: LED street lights with light poles on both sides of road
WATER SUPPLY: Potable water supply on one side of the road
ELECTRIC LINE: under ground electric line on both sides of road under street light poles
COMMON PLOT: garden and if needed electric sub station room

OWNER

ARCHITECT